

SURVEYOR'S RECORD

Section 6

Township 108

Range 41

6
7

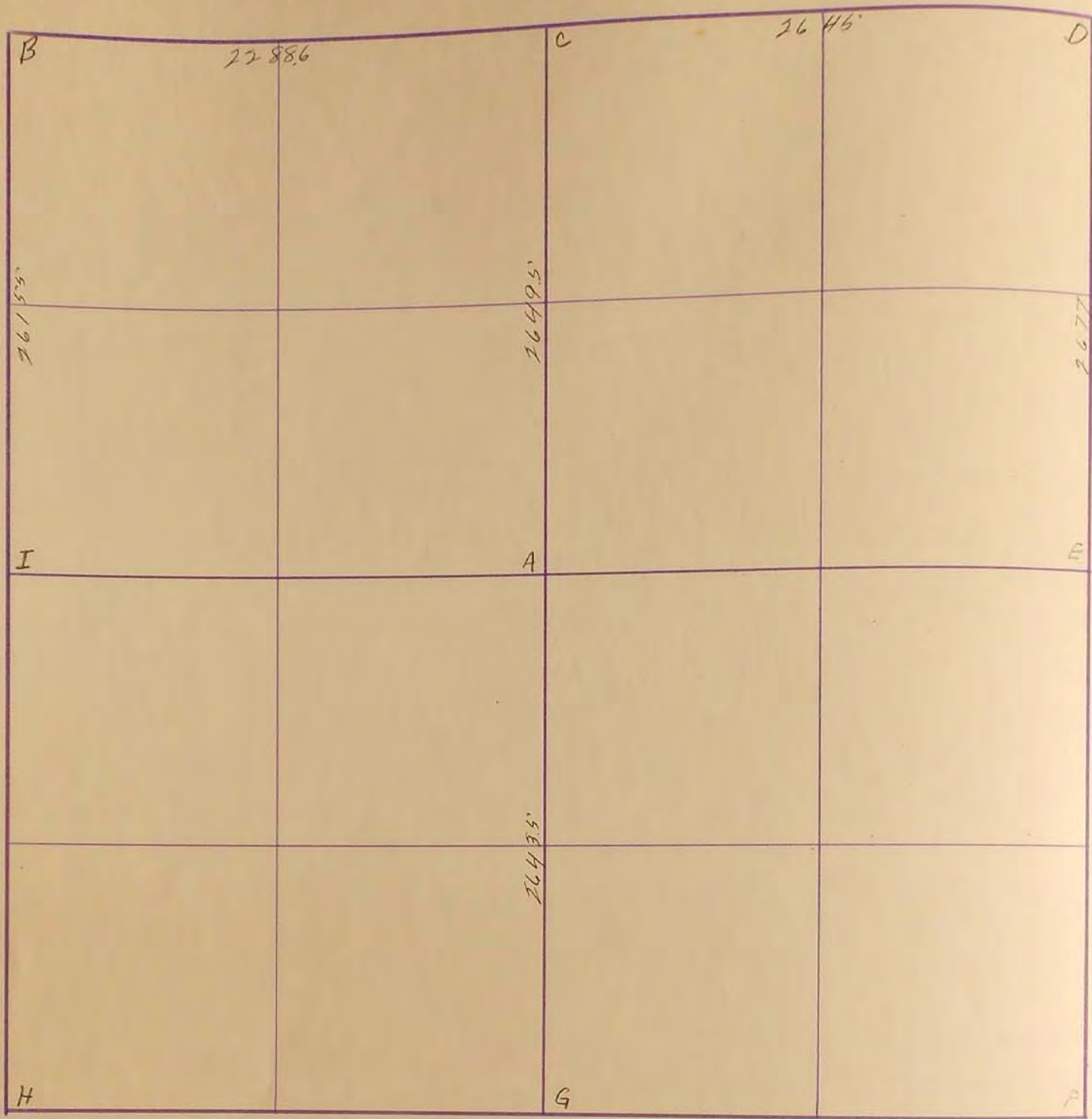

Oct 15 1910

J. H. Woodbine-off

July 3-1931

D. Stone sharp on bottom and 8x8 on top 16" long

Row of Cottonwoods on line 5-67' E. and 30' S. of cor.

4933

SURVEY No.

Section 6 Town 108 Range 41

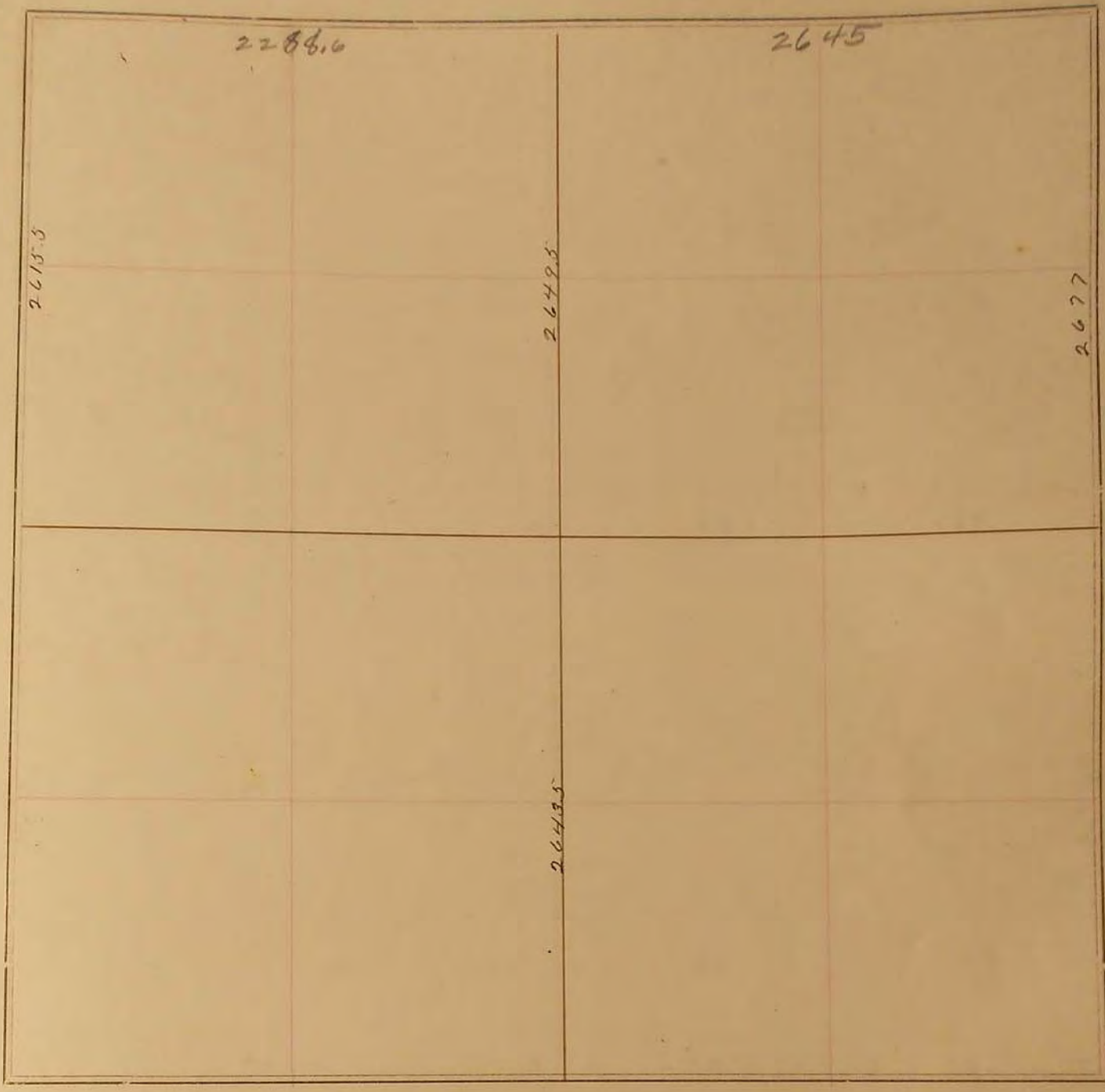

FIELD NOTES.

Oct. 15, 1910. J.W. Woolstenhulpe

July 3, 1931

□ stone sharp on bottom end. 8x8 on top. 16" long.
Row of cottonwoods on Sec. 5. 67' East and 30' South of corner.